

# Guided type fall arrester including rigid anchor line - H-8 System

(EU) 2016/425  
DIN EN 353-1:2018

Hailo SSL-8-R1 Fall Arrester and  
Integrated BFD-50/8-1 Shock Absorber

Information booklet  
about

- Using
- Care
- Inspection

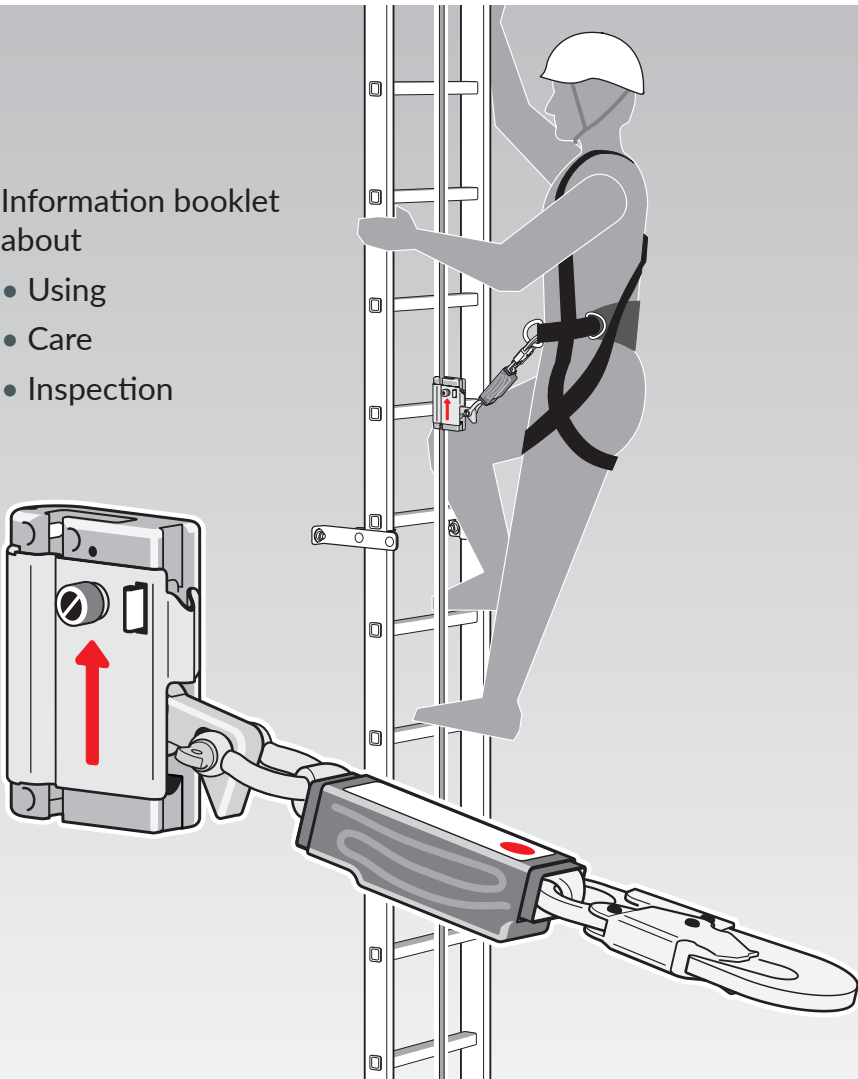

# 1. General information, explanation of symbols



This information booklet describes how to use, maintain and test the SSL-8-R1 fall arrester.

For your safety, please read this information brochure carefully before use.

## Manufacturer:

HAILO-Werk

Daimlerstr. 2,  
35708 Haiger, Germany

 +49 (0) 2773 82-0

 +49 (0) 2773 82-1561

E-mail: [info@hailo-professional.de](mailto:info@hailo-professional.de)

[www.hailo-professional.de](http://www.hailo-professional.de)

## Certifying and supervising body:

TÜV Austria GmbH

Deutschstraße 10

1230 Wien, Austria

Identification no. 0408

## EU Declaration of Conformity and EU-Type Test Certificate:



The SSL-8-R1 fall arrester may only be used on the H-8 fall arrest system.

Use, maintenance and inspection must be carried out exclusively in accordance with the specifications in this booklet.

The warranty will become null and void in the event of damage caused by non-observance of this booklet. No liability shall be assumed for any consequential damage arising from this.

For ease of understanding, this brochure has replaced the term used in DIN EN 353-1:2018, "Guided type fall arrester including rigid anchor line", with "fall arrest system".



If the fall arrester is resold to another country, it is necessary for the safety of the user that the retailer provides the user with the information in this booklet in the respective national language.



## WARNING

Notes on potentially dangerous situations.  
If these cannot be avoided, there is a risk of severe injuries or death.



## CAUTION

Notes on potentially dangerous situations.  
If these cannot be avoided, there is a risk of injuries.

## NOTE

Notes on potentially dangerous situations that may lead to property damage.



General warning advice



Risk of fatal injury in the event of a fall



Warning of hand injuries



See documentation



Use Personal Protective Equipment (PPE) against falls from a height



General instructions

### Contents:

|  |    |
|--|----|
| 1. General information, explanation of symbols | 2  |
| 2. System data                                 | 4  |
| 3. Intended use                                | 5  |
| 4. Safety instructions                         | 5  |
| 5. Technical data                              | 8  |
| 6. Use of the SSL-8-R1 fall arrester           | 9  |
| 7. Markings                                    | 14 |
| 8. Care instruction                            | 15 |
| 9. Inspection instruction                      | 15 |
| 10. Inspection plan                            | 16 |
| 11. Documentation                              | 18 |

## 2. System data

---

**Information on SSL-8-R1 fall arrester**

SSL-8-R1 fall arrester: No. ....

BFD-50/8-1 shock absorber No. ....

Expiry date: .....

---

*Date*

*Signature of manufacturer (Company stamp)*

**Information on User**

Name: ..... Company: .....

Telephone: ..... Fax: .....

Street: ..... Postcode, .....  
Town: .....

E-mail: .....

Date of the first use: .....

---

*Date*

*Signature of user*

### 3. Intended use

---

- The H-8 fall arrest system is designed as a fall safety when using rung ladders and pole climbers, both above ground and below ground. It is designed for a safe ascent and descent of service personnel to workstations at higher or lower levels.
- The SSL-8-R1 fall arrester is approved exclusively for securing persons with a total weight (body weight of the user including clothing and equipment) of 50 - 136 kg. The use of climbing aids is prohibited unless the safe usability of the combination in question has been explicitly demonstrated.
- Users of the H-8 fall arrest system, along with their fall safety personal protective equipment (PPEgA), connect to the fall arrester, which runs along the entire length of the ladder system. (see page 6).
- The fall protection system may only be used within the operating conditions described in this information booklet. Any other use (e.g. as workplace positioning or as an anchor point) is prohibited and can lead to failure of the safety system in the event of a fall. No liability is assumed for personal injury or property damage resulting from violations of the provisions outlined in this booklet or from failure to comply with the safety instructions.

### 4. Safety instructions

---

- Only persons who have been instructed in the use of vertical ladder and fall protection systems may use the H-8 fall protection system and the SSL-8-R1 fall arrester. The user of the fall arrest system must be physically and mentally capable of movement using the respective equipment. Safety in normal or emergency conditions must not be compromised.
- The contractor or operator of a plant must put in place a plan which covers all possible emergencies that might arise when using the fall arrest system and outlines the measures required for rescuing personnel.
- The accident prevention regulations DGUV regulation 1 and DGUV rules 112-198/199 (Germany) must be respected. Testing must adhere to the respective national operating and testing regulations.
- No changes or additions may be made to the H-8 fall protection system without the prior written consent of Hailo. Repairs may only be carried out using original parts and in accordance with Hailo's instructions.
- The SSL-8-R1 fall arrester is designed for use in temperatures ranging from - 40°C to + 50°C. The safe function of the fall arrester can be impaired e.g. by extreme climatic conditions, chemicals, contamination or mechanical influences (sharp edges, oil, ice, etc.). Use in this case is prohibited.
- No more than 3 persons may use the fall arrest system at the same time. The distance between individual users must be at least 6 m.

## 4. Safety instructions

- The SSL-8-R1 fall arrester should only be personally assigned to one user.
- When using a combination of equipment parts (e.g. combining a user-specific safety harness with the SSL-8-R1 fall arrester), it is a mandatory requirement that this should not result in any impairment of the overall system. In the event of a fall, any impairment may result in the failure of the fall arrester.
- Only approved safety harnesses according to EN 361 may be used.
- For reasons of safety, the user is not permitted to grip or manipulate the fall arrester while climbing or descending, except when the user is in a position of safety and there is no risk of falling.
- A visual inspection of the fall protection system and an inspection of the functionality of the fall arrester must be carried out before each use, (see page 11+12).  
If there is any doubt about the safe use of the device, or if the device has been damaged as a result of a fall, it must be immediately withdrawn from use and returned to Hailo for inspection and repair.  
In the event of a fall, the ladder and the fall arrester rope must also be inspected by a competent/qualified person before further use.
- Additional lanyards are required when leaving the fall protection system. These should be as short as possible in order to reasonably limit the fall distance.
- Additional attaching elements, e.g. Y harnesses, should only be attached to the fastening-points provided for them (EN 795).

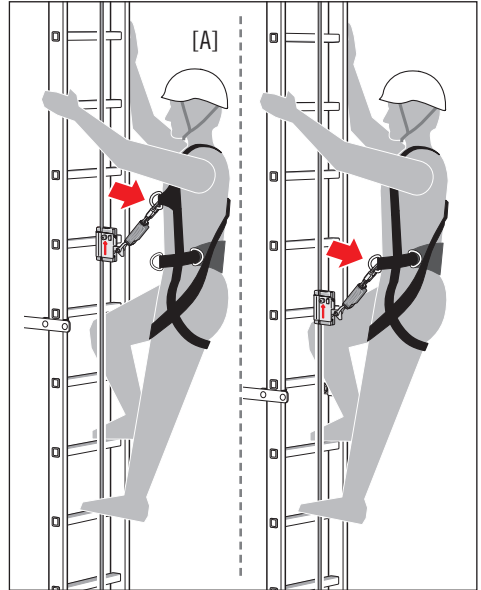

### WARNING

#### Risk of falling!

The spring hook on the shock absorber may only be attached to the authorised retaining eye on the safety harness [B].

The fall arrester must not be connected to any retaining eyes to the sides of the safety harness that may be provided as an additional element in the hip area.

The safety harness must sit firmly on the body and be correctly adjusted [C], [D].

A loose safety harness is prohibited when using the fall protection system [D] [E].

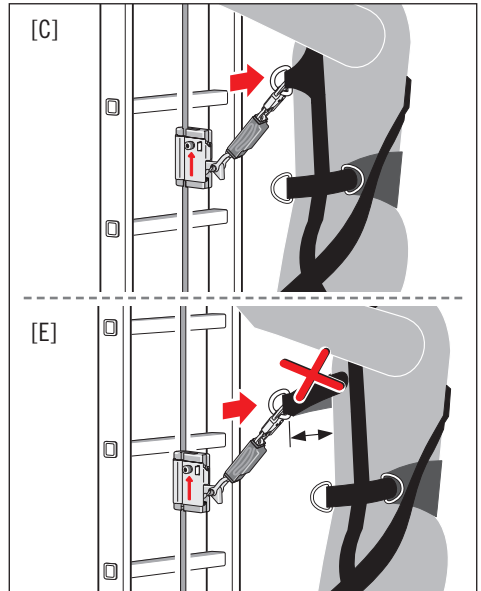
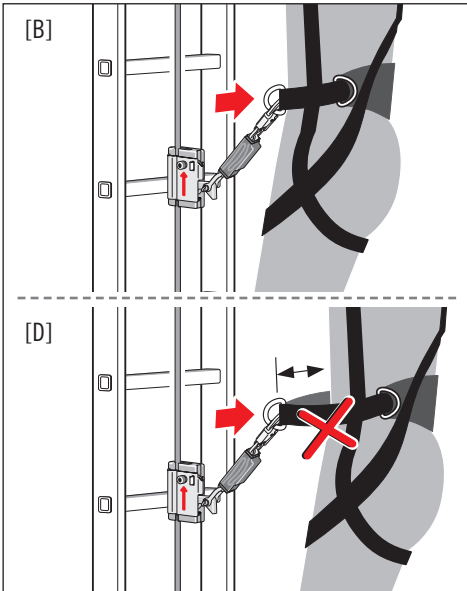

 **WARNING**  
**Risk of falling!**

The user should avoid standing in a position directly on the fall arrester rope above the fall arrester [F].  
There is a danger of falling!

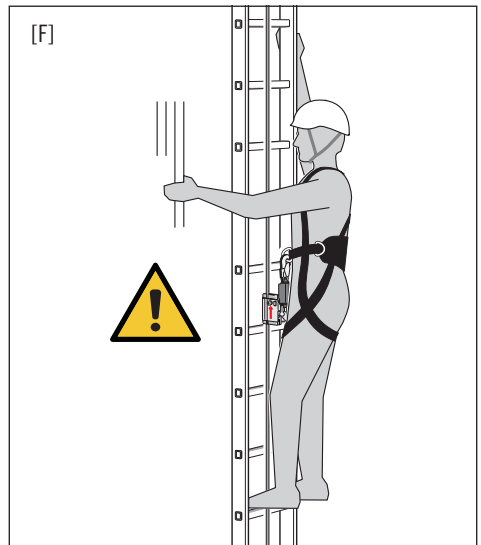

# 5. Technical data



The SSL-8-R1 fall arrester on the H-8 fall arrest system does not provide protection when the user is on the lower section of the climbing unit (i.e. < 3 m from the top edge – access level).

The plant operator must install an appropriate warning notice on the building to inform the user beyond all doubt of the safe distance.

The H-8 fall arrest system must be identified with a type plate at the point of access which indicates the type of fall arrester to be used with the H-8 fall arrest system.

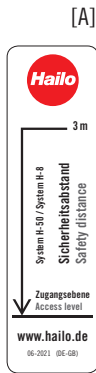

[A]

[B]

**HAILO System H-8** Das System H-8 darf ausschließlich mit dem Auffanggerrät SSL-8-R1 in Verbindung mit Aufhängeturm nach EN 361 genutzt werden.

**ACHTUNG!**

- Die Schutzwirkung des Auffanggerrätes ist ab 3 m Stieghöhe über Zugangsebene gegeben! (Sicherheitsabstand = 3 m)
- Zwischen zwei steigenden Personen ist ein Abstand von mindestens 6 m einzuhalten.
- Max. 3 Personen dürfen das Stiegschutzsystem gleichzeitig benutzen.

**HAILO H-8 System** The H-8 system may only be used with the SSL-8-R1 fall arrester in conjunction with EN 361 compliant safety belts.

**ATTENTION!**

- The safety harness provides protection from a height of 3 m above the access level! (Safety distance = 3 m)
- There should always be a gap of at least 6 m between any two people on the fall arrest system.
- No more than 3 persons may use the fall arrest system at any one time.

**HAILO Système H-8** Le système H-8 doit être utilisé exclusivement avec l'artichute SSL-8-R1 et avec des harnais de sécurité selon EN 361.

**ATTENTION !**

- L'effet protecteur de l'artichute n'est réalisé qu'à partir de 3 m de hauteur au-dessus du niveau d'accès! (distance de sécurité = 3 m)
- Entre deux personnes utilisant l'accès une distance d'au minimum 6 m doit être respectée.
- 3 personnes au maximum peuvent utiliser en même temps le système de protection d'accès en hauteur.

**Informationen/Instructions beachten!**  
Zielbedingte bei den Montageanweisungen bzw. Anweisungen. Montiert Nächste Prüfung  
For assembly, refer to tick as applicable. disassemble Next inspection  
Lire attentivement le manuel d'instructions. démontez Prochaine inspection  
Pour le montage, référez au manuel selon le cas. Montez Prochaine inspection

**06-2022 (DE-GB-FR)** Hailo-Work • Daimlerstraße 2 • 35176 Hainig, Germany

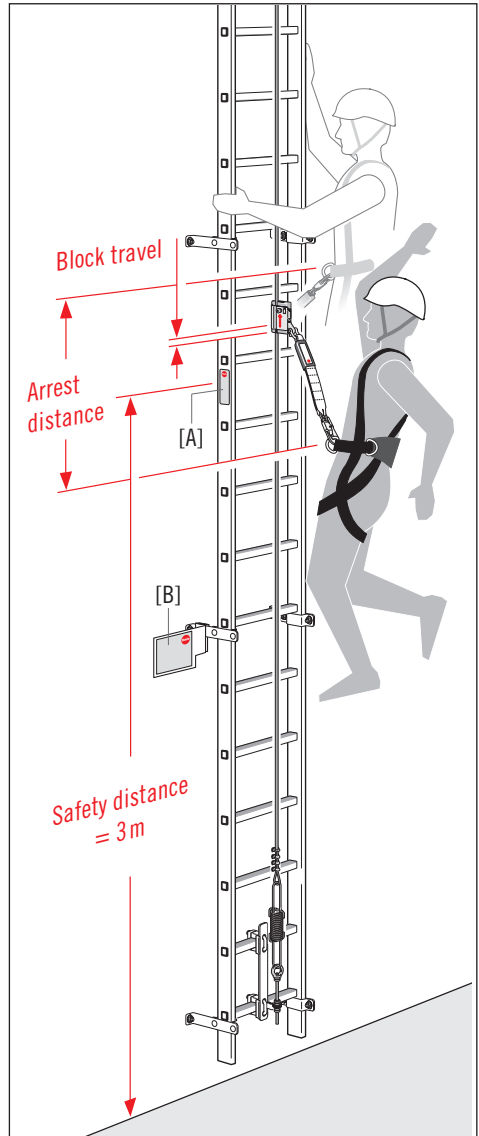



## 6. Use of the SSL-8-R1 fall arrester

Fall arrester SSL-8-R1 with integrated shock absorber BFD-50/8-1

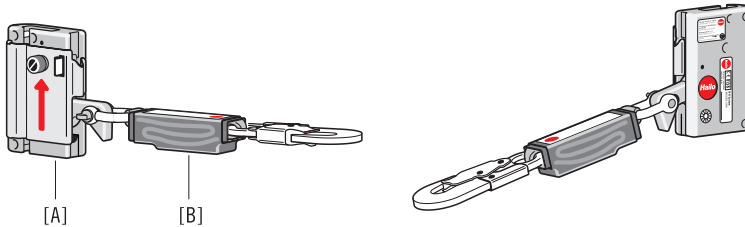

- The fall arrester SSL-8-R1 [A] is locked to the fall arrester rope before climbing/descending. The fall arrester when attached to the rails is fitted with a BFD-50/8-1 shock absorber [B] and is connected to the user's safety harness.
- The fixed and integral BFD-50/8-1 shock absorber (DIN EN 353-1:2018) must be replaced on reaching its expiry date. The shock absorber may only be replaced by the manufacturer.



The fall arrester may only be used in the correct direction of pull (red arrow pointing upwards).

Before using the fall protection system with the accompanying fall arrester SSL-8-R1, check that the system is functioning properly (see page 12).



### CAUTION!

#### Danger of pinching!

In case of careless handling, fingers or skin can get squeezed between the housing parts.

## 6. Use of the SSL-8-R1 fall arrester

### Attaching and removing the fall arrester SSL-8-R1

1. Before using the fall arrester, the fixed and integral spring hook on the shock absorber must be clipped onto the retaining eye on the safety harness, which should be put on beforehand - in accordance with EN 361.  
Observe the safety instructions on page 5-8!
2. The fall arrester must be attached to the arrester rope in the correct direction of pull (red arrow pointing upwards [D] ).
3. When attaching the fall arrester, ensure that the thumb grips the fall arrester and the index finger is below the brake lever [E] when pulling the brake lever upwards.
4. Use the other hand to loosen the knurled thumb screw [F] and release the lock on the cover [G], while at the same time opening the cover.



5. After it the fall arrester has been attached, close the cover [H] and tighten the knurled screw [F].

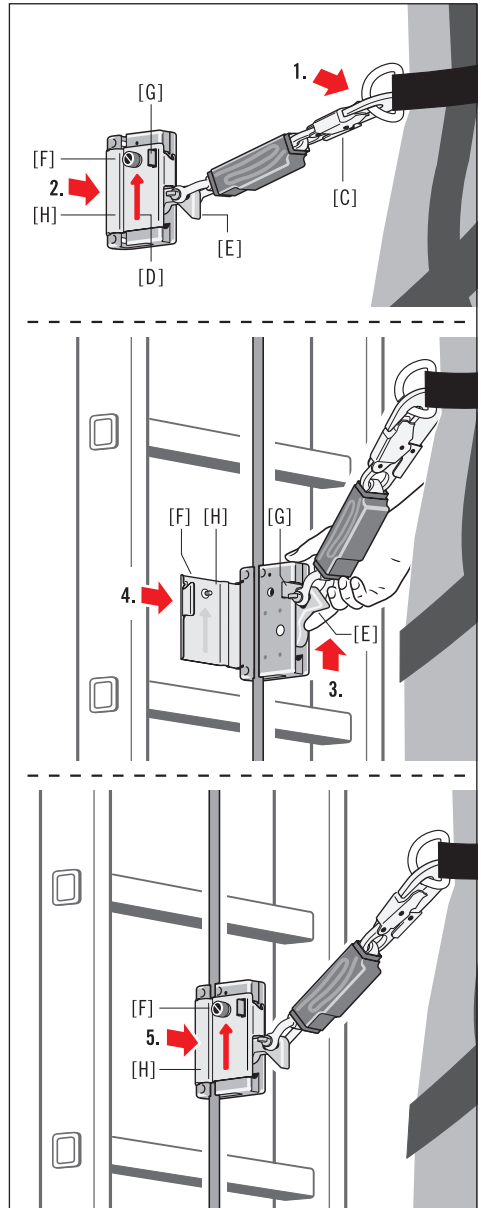

### General check and function test

- The SSL-8-R1 fall arrester must first be checked visually prior to use.
- The fall arrester should only be attached to the wire cable in the correct direction of pull (i.e. with the arrow pointing upwards). The shock absorber must move freely on the fall arrester.
- When the shock absorber is pulled upwards, the fall arrester must be unlocked and run easily up and down the wire cable.
- When the shock absorber is released, the fall arrester must lock on the fall arrester rope within 30 mm without slipping.
- The fall arrest effect is not operative if, during climbing or descent, a horizontal force is acting on the fall arrester. This will obstruct the fall arrester.
- When the SSL-8-R1 fall arrester has been tested successfully to ensure it is working properly, it is ready for use and the user can climb or descend in safety.
- If there is any doubt as to whether it can be used safely, the fall arrester must be taken out of service immediately.

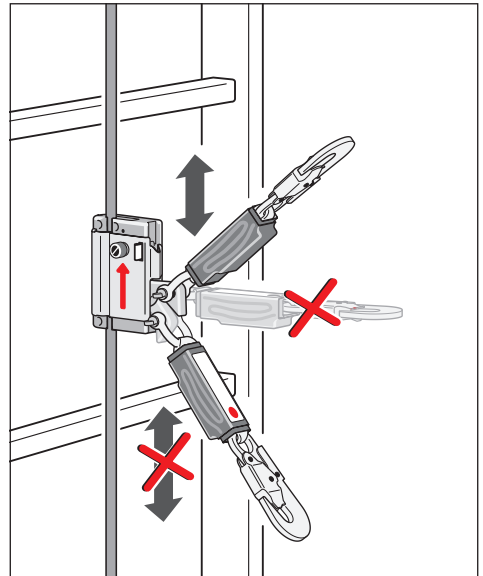

## 6. Use of the SSL-8-R1 fall arrester

### Daily functional testing before using the H-8 fall arrest system



Carry out this test before using the H-8 fall arrest system.

Make sure you are in a safe position before carrying out the functional test.

1. Attach the SSL-8-R1 fall arrester into the fall arrest rope at head height. Then connect the fall arrester to the chest eyelet of your harness.
2. Allow the whole weight of your body to hang vertically down.
3. The SSL-8-R1 fall arrester must now be anchored in the rope and unable to slip.



If the SSL-8-R1 fall arrester slips during this safety test, you must stop using it immediately and return it to the manufacturer for inspection.

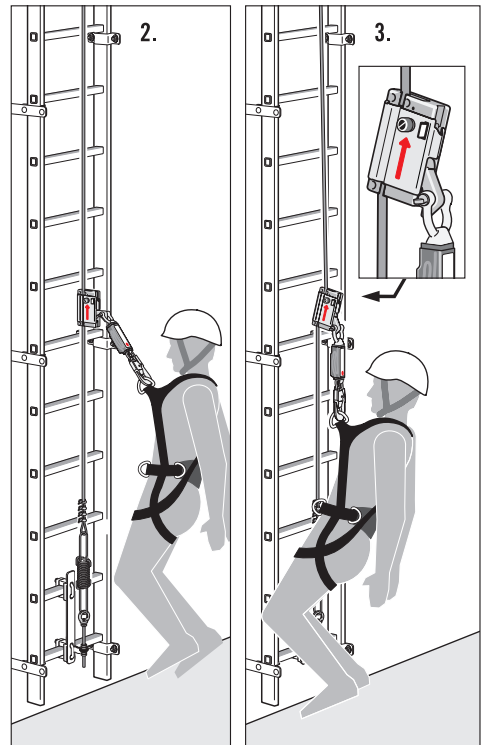
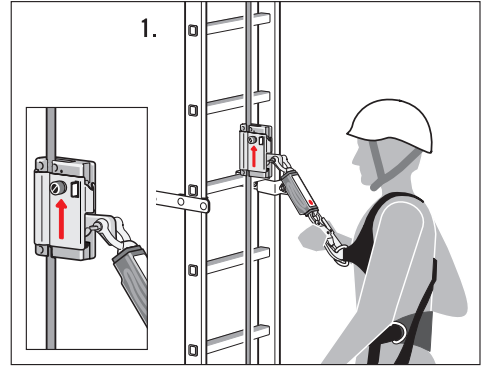

## Additional anchor points



### WARNING

#### Risk of falling!

Both on entering and leaving the fall arrest system, the user must be secured to an approved fastening point appropriate to local conditions to prevent falling.

The karabiner [A] is either hooked onto an approved anchor point [B] - according to EN 795 - or another structure!

The system may only be entered or left from a safe standing position.

At no time should there be any risk of falling!

- Stop points and stop devices used in a climbing system are to be positioned such that free falling and the fall height are restricted to a minimum. The fastening point must be within the radius of action for the user while still secured.
- In general, the user should always select stop devices/stop points that are situated above them.

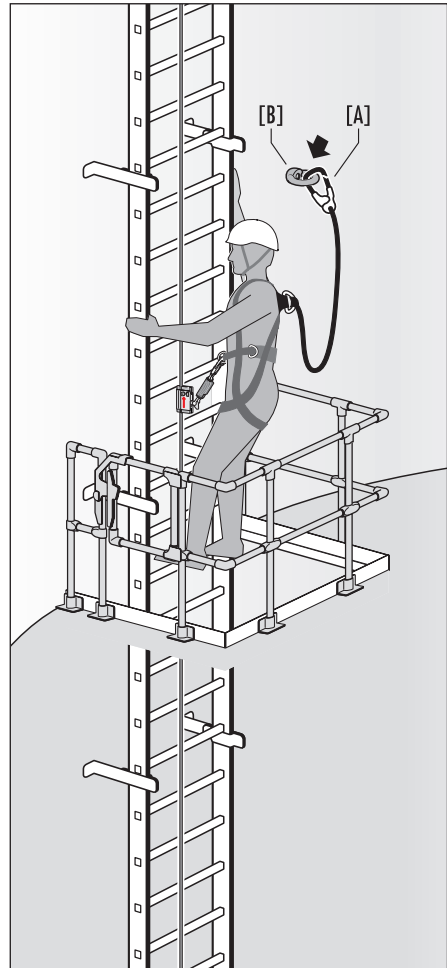

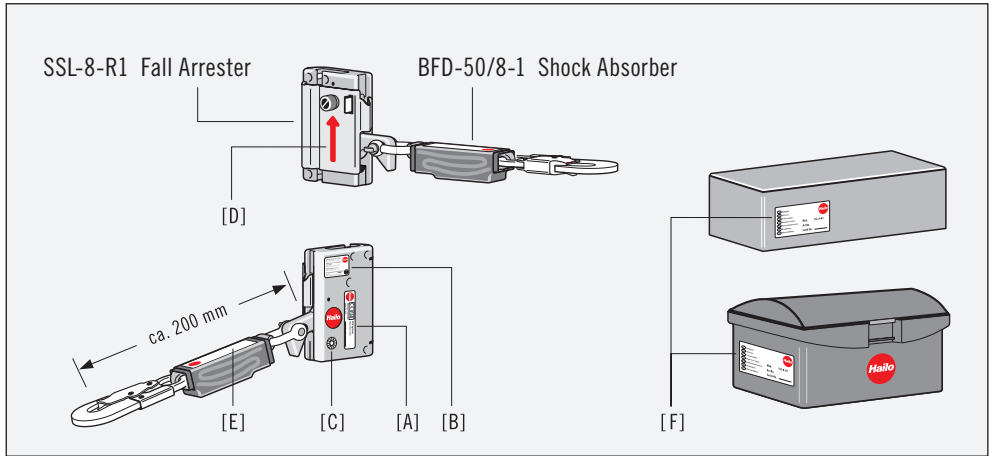

# 7. Markings



- [A] Type plate on SSL-8-R1 fall arrester
- [B] Security advice
- [C] Test badge
- [D] Arrow marking THIS WAY UP
- [E] Type plate on BFD-50/8-1 shock absorber
- [F] Packaging label





[A]  **CE 0408** **H-8 System**  
 Fall arrester / Serial number **DIN EN 353-1:2018**  
**Hailo SSL-8-R1**

[B] **Zulässiges Gewicht 50 - 136 kg**  
 Allowable weight 50 - 136 kg  
**Verwendung nur mit Auffanggurt nach EN 361**  
 Use full-body-harness EN 361  
**Meigungswinkel 0°/+15°**  
 Angle of inclination 0°/+15°  
**Achtung! Informationsbrochüre beachten**  
 Attention! Please read the information manual. 

[C] 

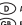
[D] 

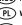
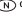
[E] **Typ: BFD 50/8 - 1** **Hailo**  
**DIN EN 353-1:2018** Hailo Werk, Rudolf Loh GmbH & Co. KG  
 Daimlerstraße 2, 35708 Haiger, Germany  
 Herstellungsjahr / Year of manufacture: XXXXX  
 Herstellungsnummer / Factory number: 00001  
 Verwendung / Use: max. X Jahre / X years siehe / see 

[F]   
 Aufhängesitz  
 Fall Arrester  
 Protection anseiche  
 Dispositivo de retención  
 Устройство задерживающее  
 Wzrostki i hamulce  
 Oude en fallreger

**Mod. SSL-8-R1**  
**Art.No.** \_\_\_\_\_  
**Serial-No.** \_\_\_\_\_

## 8. Care instruction

---

### Cleaning:

- Remove soiling from the fall arrester using only water and an acid-free detergent.
- The fall arrester should be allowed to dry naturally. Drying underneath or against heat sources is not permitted.

### Storage:

- The SSL-8-R1 fall arrester must be stored in a dry location to which the user has access. Temperatures  $< -40\text{ }^{\circ}\text{C}$  or  $> +50\text{ }^{\circ}\text{C}$  or contact with oils, acids or other corrosive liquids is not permitted.
- The SSL-8-R1 fall arrester can be stored and transported in the supplied packaging or a suitable container.

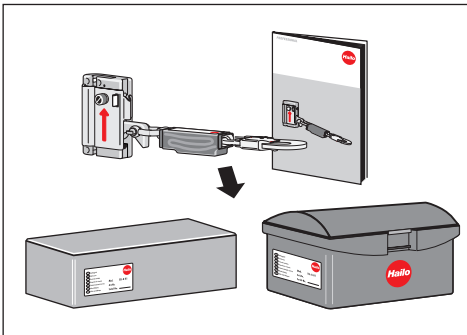

### NOTE

#### Caution, damage!

Inexpert storage or transport may result in damage to the SSL-8-R1 fall arrester and thus to failure in the event of a fall.

## 9. Inspection instruction

---

- DIN EN 353-1:2018-compliant fall arresters must be inspected and documented for good working order and functionality at least once a year by trained/authorised personnel.
- The testing of all components, each individual subsystem and system must be documented.
- In addition, regular checks must be made depending on the respectively applicable environmental conditions. This can mean that the intervals between testing are correspondingly shortened.
- The plant operator is responsible for ensuring that testing and maintenance intervals are observed.



Testing must adhere to the respective national operating and testing regulations.



### WARNING

#### Risk of falling

Regular checks of the equipment are a mandatory requirement. The safety of the user is dependent on the effectiveness and the durability of the equipment.

## 10. Inspection plan

### Test schedule for regular testing of the SSL-8-R1 fall arrester

Annual tests are to be documented in the tables below by trained/authorised personnel.

Result:

In the event of a claim, this documentation must be available in full as evidence. The manufacturer must be granted access to this at all times.

|   |   |
|---|---|
| 1. SSL-8-R1 fall arrester - general condition | <i>Check for damage, corrosion and contamination</i>              |
| 2. Fall arrester housing                      | <i>Technical condition</i>  |
| 3. Housing cover                              | <i>Hinge function; technical condition</i>                        |
| 4. Screw plugs for lid                        | <i>Closing function</i>   |
| 5. Cover locking spring                       | <i>Closing and locking function</i>                               |
| 6. Brake lever                                | <i>Movement, functional surfaces and technical condition</i>      |
| 7. Brake lever – recuperating spring          | <i>Impact and condition</i>                                       |
| 8. Brake pad                                  | <i>Movement; guide function; condition</i>                        |
| 9. Brake pad                                  | <i>Condition of recuperating spring assemblies; effectiveness</i> |
| 10. Brake shoe                                | <i>Seat; screw fixing; condition</i>                              |
| 11. Anti-twist lock                           | <i>Movement; function; condition</i>                              |
| 12. Screw connections                         | <i>Technical condition and preload force</i>                      |
| 13. Cylinder pin (brake lever)                | <i>Seat, condition and any safety coating</i>                     |
| 14. Pins and dowel pins                       | <i>Seat and condition</i>   |
| 15. Shackle                                   | <i>Lock pin (safety sticker)</i>                                  |
| 16. BFD-50/8-1 shock absorber                 | <i>Condition</i>  |
| 17. BFD-50/8-1 shock absorber                 | <i>Condition of packaging in heat-shrunk sleeve</i>               |
| 18. Karabiner clip                            | <i>Condition, function and safety catch</i>                       |
| 19. Original markings                         | <i>Are the serial number, type details, etc., easily legible?</i> |
| 20. SSL-8-R1 function test                    | <i>Use on H-8 fall arrest system</i>                              |
| 21. Period of use of BFD 50/8-1               | <i>Has the period of use expired?</i>                             |
| 22. Test badge for SSL-8-R1 fall arrester     | <i>Has a test badge been awarded?</i>                             |

– Copy this double page when additional information needs to be entered –





# 11. Documentation

## Inspection of the SSL-8-R1 Fall Arrester

|   |   |                              |
|---|---|------------------------------|
| <i>Product description</i><br><b>SSL-8-R1 fall arrester</b> | <i>Manufacturer / Supplier</i><br>HAILO-Werk<br>Daimlerstraße 2, D-35708 Haiger   | <i>Date of purchase</i>      |
| <i>Identification mark</i><br>Serial number                 |  +49 (0) 2773 82-0<br> +49 (0) 2773 82-1561 | <i>Date of the first use</i> |
| <i>Date of manufacture / Expiry date</i>                    | info@hailo-professional.de<br>www.hailo-professional.de   | <i>Further information</i>   |

Documentation of the regular inspections / repairs to the SSI-8-R1 fall arrester

| <i>Date</i> | <i>Reason of work: a) Regular check, b) Repair</i><br><i>Test outcome of the periodic inspection</i> |  |
|-------------|--|--|
|             |  |  |
|             |  |  |
|             |  |  |
|             |  |  |
|             |  |  |
|             |  |  |

Documentation covering regular replacement of BFD-50/8-1 shock absorber

| <i>Date</i> | <i>New production number - BFD-50/8-1 shock absorber</i> | <i>Expiry date</i> |  |
|-------------|--|--------------------|--|
|             |  |                    |  |
|             |  |                    |  |

# Inspection of the BFD-50/8-1 Shock Absorber

|  |   |                              |
|--|---|------------------------------|
| <i>Product description</i><br><b>BFD-50/8-1 shock absorber</b> | <i>Manufacturer / Supplier</i><br>HAILO-Werk<br>Daimlerstraße 2, D-35708 Haiger<br> +49 (0) 2773 82-0<br> +49 (0) 2773 82-1561<br>info@hailo-professional.de<br>www.hailo-professional.de | <i>Date of purchase</i>      |
| <i>Identification mark</i><br>Serial number                    |   | <i>Date of the first use</i> |
| <i>Date of manufacture / Expiry date</i>                       |   | <i>Further information</i>   |

| <i>Repairs carried out</i> | <i>Name and signature of expert</i> | <i>Date of next regular check</i> |
|----------------------------|-------------------------------------|-----------------------------------|
|                            |                                     |                                   |
|                            |                                     |                                   |
|                            |                                     |                                   |
|                            |                                     |                                   |
|                            |                                     |                                   |
|                            |                                     |                                   |
|                            |                                     |                                   |
|                            |                                     |                                   |
|                            |                                     |                                   |
|                            |                                     |                                   |

| <i>Bearbeiter(in) - Name und Unterschrift</i> |
|---|
|   |
|   |
|   |
|   |

The information concerning the BFD-50/8-1 shock absorber is to be entered by the manufacturer and its replacement is to be documented in the table.

The BFD-50/8-1 shock absorber may only be replaced by the manufacturer:

- a) Replace shock absorber and shackle
- b) Fit shackle bolts with safety stickers

